



## HUBBELL iStation Audio/Video Connectors, Pro-AV 1/4" Locking Stereo

**iSTATION™** Front-Loading Footprint.

Use With Mono and Stereo Audio Applications.

1/4" Plug Locking System.

Standard 1/4" Stereo Jack.

Metal insert in locking area.



High-performance 1/4" stereo jack.

Universally accepted standard Pro-AV panel mount housing.

Professional Audio/Video grade connection.

### SPECIFICATIONS

- ◆ **Electrical:** Insulation Resistance: 2 x 10<sup>6</sup> M(ohm) at 500 V DC per MIL-STD-202, method 302 (initial). Dielectric Strength
- ◆ **Mechanical:**  
Mating Cycles 10,000+
- ◆ **Material:**  
Shell: Die-cast Zinc, with satin Nickel-plating. Black chrome over Nickel-plating on special order.  
Insert and Latch: Thermoplastic, UL 94V-0.  
Latch Release: Nickel-plated die-cast Zinc.  
Contact Springs: Tin-plated copper alloy.
- ◆ **Environmental:**  
Thermal Range: -55°C to +85°C (non-operating); -20°C to +65°C (operating).  
Thermal Shock: Per MIL-STD-202, method 107.  
Humidity: Per MIL-STD-202, method 106.  
Salt Spray: Per MIL-STD-202, method 101.

Hubbell's Pro-AV 1/4" Locking Stereo Connector provides the perfect solution to connect professional and commercial grade Audio components. Pro AV equipment and legacy electronic devices are standardized on the 1/4" stereo jack for audio and (unbalanced) microphone inputs and outputs.

Hubbell's Pro-AV 1/4" Locking Stereo connector delivers high quality audio signal and protection to and from devices. Simply install the 1/4" Locking Stereo connector into **iSTATION™** AV Blank module and front load into any **iSTATION™** product, Hubbell Delivery System products including poke throughs and raceway, or **iSTATION™** UDX multimedia panels. AV-Blank modules are available in 7 standard colors.

Create a customized multimedia work station outlet by adding a Pro-AV 1/4" Locking Stereo connector along with Hubbell's extensive line of AV connectors, **iSTATION™** modules and **XCELERATOR™** jacks.

### CABLE TERMINATION

**Cable Type:** 16-26 AWG 2 conductor, w/shield (served bare copper shield preferred).

### APPLICATIONS SUPPORTED

- ▲ Pro audio equipment, amplifiers, mixing boards, microphones.
- ▲ With a male adapter the 1/4" can be converted to a 3.5mm or vice-versa to distribute audio from device to device.

### CONNECTOR TERM

**1/4" Stereo Connections** - TS and TRS (phono style jacks and plugs) connections are available in three standard sizes 1/4", 3.5mm or miniature and 2.5mm or subminiature. The 1/4" stereo connection is one of the oldest audio connections dating back to the late 1800's.

### INSTALLATION TIPS

**Soldering Tips:** Cleanliness - Temperature - Time - Solder Coverage - These key factors affect the quality of the joint.

A little effort spent in soldering a perfect joint will eliminate a considerable amount of time in troubleshooting a defective joint in the future.

**Important:** Always allow for clearance behind connection location to ensure for proper bend radius and patch cord connector depth.

**AV Connector, Pro-AV 1/4" Locking Stereo**

Qty. \_\_\_\_\_ Catalog No. \_\_\_\_\_  
 10-pack **14S10**

**AV Modules, Pro-AV Blank**

Description \_\_\_\_\_ Catalog No. \_\_\_\_\_  
 Pro-AV Blank, Unloaded, 1.5 Unit, 10-pk **IMAVB15XX**

**XX = Housing Colors**

"AL" = Almond; "BK" = Black; "EI" = Electric Ivory; "GY" = Gray;  
 "LA" = Light Almond; "OW" = Office White; "W" = White.

**CONNECTOR DEFINITION**

1. Sleeve: usually ground.
2. Ring: Right channel for stereo signals, negative phase for balanced mono signals.
3. Tip: Left channel for stereo signals, positive phase for balanced mono signals, signal line for unbalanced mono signals
4. Insulating rings.

	Unbalanced	Balanced	Stereo
Tip	Signal	Positive "Hot"	Left Channel
Ring	Not available	Negative "Cold"	Right Channel
Sleeve	Ground Return	Ground	Ground

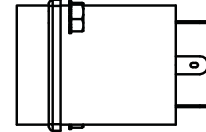
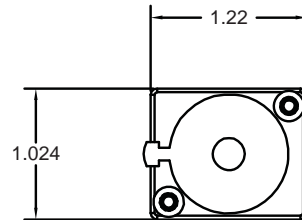
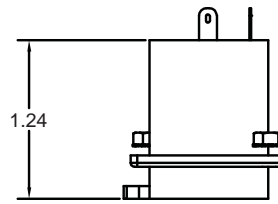
**DIMENSIONS****iSTATION™ COMPATIBLE****Work Station and Cross-Connect Solutions**

- iSTATION™ Front-loading Plates
- Decorator Frames
- iSTATION™ UDX Multimedia Panels
- iFRAME® Vertical Patch Panel

**Hubbell Delivery Systems**

- Hubbell SystemOne Poke-Throughs and Floor Boxes
- Hubbell Surface Raceway, Metal and Non-Metallic
- Multi-Connect™ Wall Boxes/Conference Table Boxes

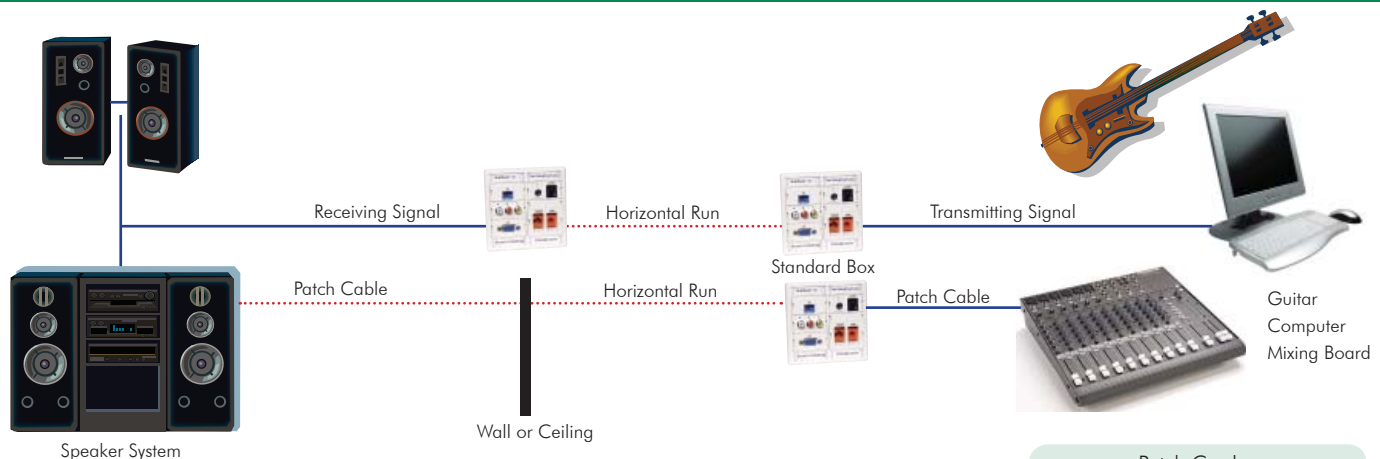
**TYPICAL APPLICATIONS**

— Patch Cords  
 ..... Horizontal Cable



Pro-AV, 1/4" Stereo Jack  
 Connector in Hubbell  
 iSTATION™ face plate.

**Hubbell Premise Wiring**

HUBBELL INCORPORATED (Delaware)  
 14 Lord's Hill Road • Stonington, CT 06378-0901 • (860) 535-8326 • 800-626-0005  
 Fax: (860) 535-8328 • Internet site: <http://www.hubbell-premise.com>

**Worldwide Locations**

Hubbell Premise Wiring, Asia Pacific  
 Hubbell Canada Inc.  
 Hubbell Premise Wiring, Central America  
 Hubbell Premise Wiring, China  
 Hubbell Premise Wiring, Europe  
 Hubbell Premise Wiring, India  
 Hubbell Int'l. Inc., Korea Branch

852-2836-7131  
 905-839-1138  
 506-309-4158  
 86-21-6374 2660  
 44-01283 500500  
 91-80-4022-4089  
 (82 2) 2607 1363

Fax: 852-2836-7132  
 Fax: 905-839-9108  
 Fax: 506-260-1616  
 Fax: 86-21-6374 2799  
 Fax: 44-01283 500400  
 Fax: 91-80-4022-4033  
 Fax: (82 2) 2603 7386

Hubbell Premise Wiring, Latin America  
 Hubbell de Mexico, S.A. de C.V.  
 Hubbell Premise Wiring, Middle East  
 Hubbell Premise Wiring, Puerto Rico  
 Hubbell-Taian Co., Ltd., Taiwan  
 Hubbell Premise Wiring, Venezuela

305-408-4501  
 (5255) 9151-9999  
 971-4-393-4192  
 787-855-1075  
 886-2-2522-1862  
 58-212-5156482

Fax: 305-408-8201  
 Fax: (5255) 9151-9989  
 Fax: 971-4-393-4194  
 Fax: 787-855-3265  
 Fax: 886-2-2522-1872  
 Fax: 58-212-6627258