

To obtain information on AMP NETCONNECT\* products, call PRODUCT INFORMATION at the number at the bottom of this page, or visit the AMP NETCONNECT website at [www.ampnetconnect.com](http://www.ampnetconnect.com).

Figure 1

## 1. INTRODUCTION (Figure 1)

This instruction sheet provides termination procedures for the SL Series 110Connect (Cat 3, Cat 5e, and Cat 6) modular jacks; the KL Series 110Connect (Cat 5e and Cat 6) modular jacks; and Secure SL Series 110Connect (Cat 6) modular jacks.

### NOTE



All dimensions are in millimeters [with inches in brackets]. Figures and illustrations are for reference only and are not drawn to scale.

Reasons for reissue of this sheet are provided in Section 4, REVISION SUMMARY.

## 2. DESCRIPTION

The jacks accept four pair, twisted-pair cable with 22 through 24 AWG solid conductors and 24 AWG stranded conductors. The maximum conductor insulation diameter is 1.45 mm [.057 in.].

## 3. TERMINATION

- Strip back only as much cable jacket as necessary to perform termination. See Figure 2.

### NOTE



Generally, a strip length of 50.8 mm [2.00 in.] maximum will meet the needs of most applications, depending on method of termination.

### NOTE



If using the optional bend-limiting strain relief, slide it over cable jacket as shown in Figure 2.

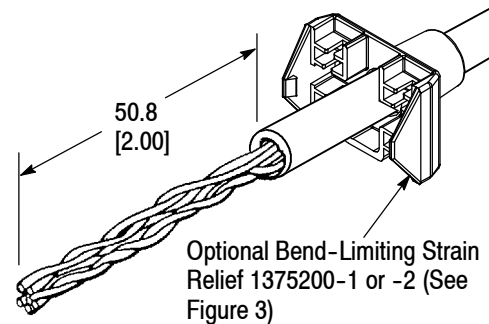

Figure 2

### NOTE



Keep wire pairs twisted to within 75 mm [3 in.] of termination for Cat 3 jacks, or 12.7 mm [.50 in.] for CAT 5e Jacks, or 6.0 mm [.24 in.] for CAT 6 Jacks.

- Align and lace a color-coded wire pair with the appropriate slots as indicated by the color coding on the wiring label (use minimum slack while maintaining twist, as indicated in Figure 3).

### NOTE



Wire termination requires the use of Impact Tool 1583608-1 or SL Jack Termination Tool 1725150-1. Refer to 408-8858 for SL Jack Termination Tool instructions.

### CAUTION



Set impact setting for low-impact. Orient tool so cutoff blade is on outside of block and vertical.

- Use tool to punch wires down into slot and cut off excess wire. Remove loose wire pieces.
- Repeat Steps 2 and 3 with all wire pairs.
- Slide bend-limiting strain relief (if used) onto jack. Latches on strain relief will engage tabs on rear of jack as indicated in Figure 3.

## 4. REVISION SUMMARY

- Updated document to corporate requirements.

AMP NETCONNECT logo is a trademark of TE Connectivity.

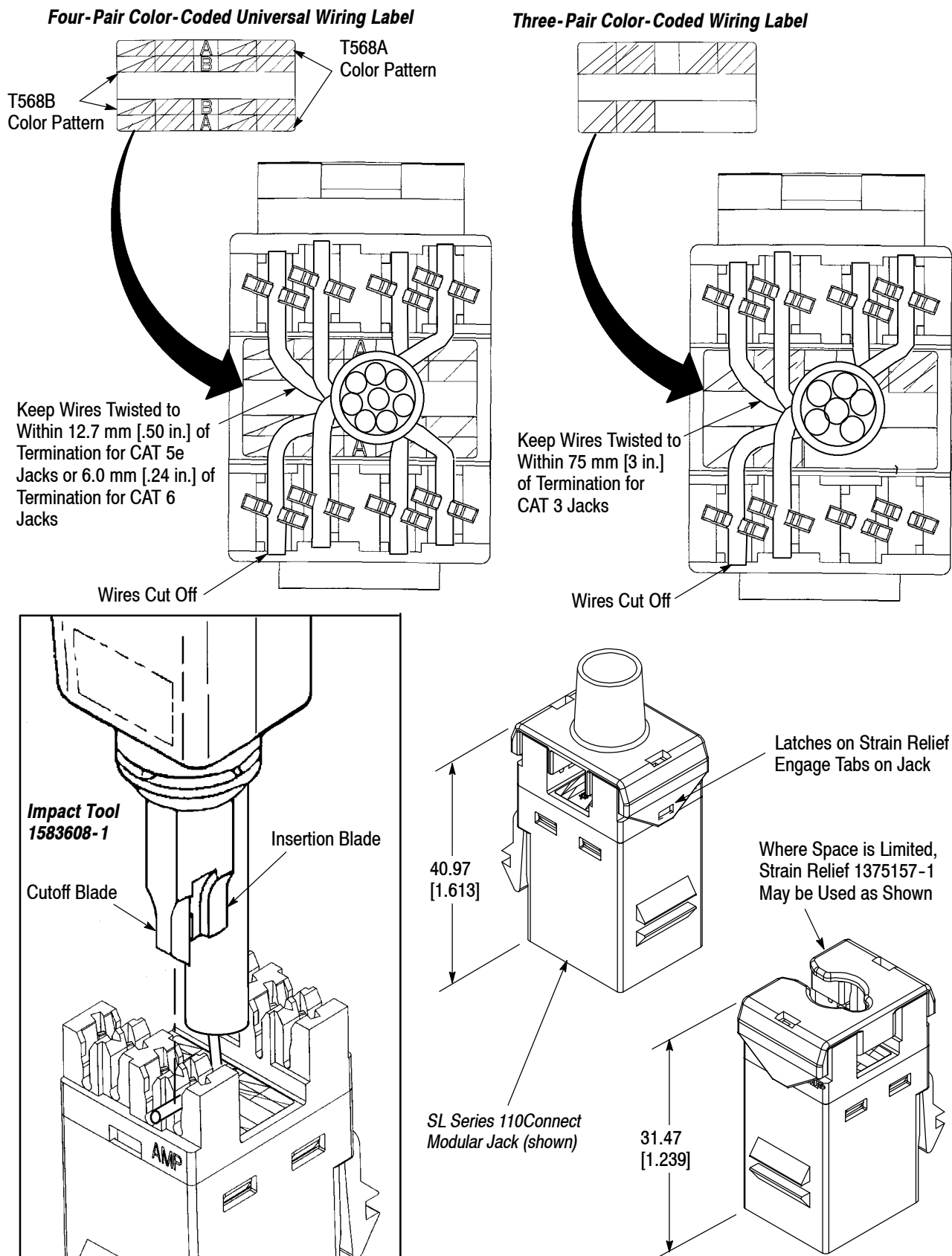

Figure 3