

PDT SERIES THIN POWER STRIPS

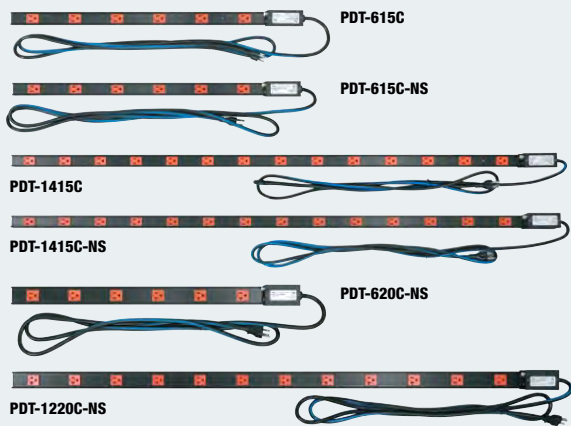

CORDED

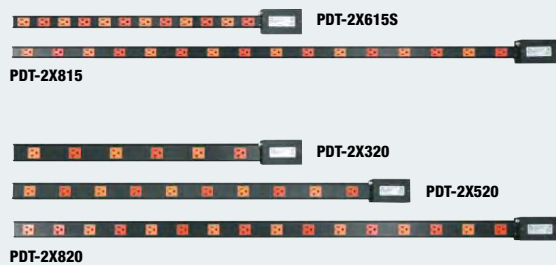

HARDWIRED

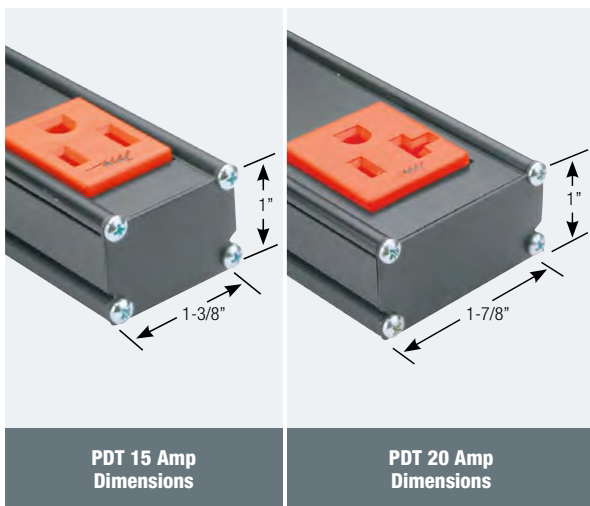

PDT 15 Amp Dimensions

PDT 20 Amp Dimensions

PDT STRIPS ARE NOW AVAILABLE FOR EVERY RACK SYSTEM

PDT Series Thin Power Strips take up minimal space inside a rack and feature a unique design that allows for isolated ground configurability. Dual circuit models can be configured to operate as a single circuit and all models are factory assembled for easy installation.



- Unique design allows for isolated ground configurability in the field
- Saves time - ships fully assembled with all needed accessories including cable management clips
- Easy to order – a single part number includes all needed accessories
- Small size uses a minimum of space
- Mounts easily with provided clips
- 15 Amp models are prewired with 12-gauge wiring and can be attached to a 20 Amp branch circuit
- Dual circuit models can be field configured to operate as a single circuit
- Surge protected models include LEDs for convenient local status indication, and also have dry contact closure for remote status notification
- Outlets are spaced to provide enough room for plug-in power supplies
- Top feed models with J-Box on the top of the power strip, available to meet code requirements in select areas
- Metered models include high visibility red LED display; indicates current to tenths of Amps
- Corded models feature SignalSAFE™ cords to virtually eliminate AC magnetic fields
- NRTL Listed in the US and Canada

STANDARD TERMINATIONS

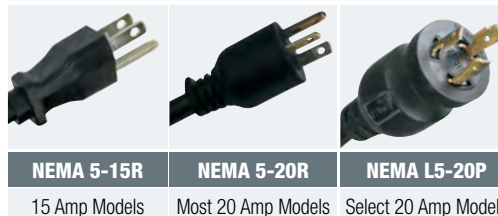

OPTIONAL TERMINATIONS FOR HARDWIRED MODELS

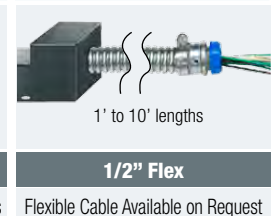

FLEXIBLE MOUNTING

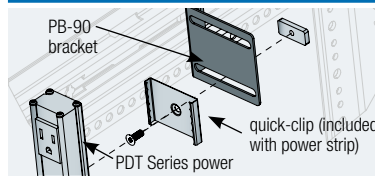

Mounts to the sides of most racks, with included quick clips.

Can be oriented towards the front or back with optional PB-90 brackets.

PDT SERIES ENHANCED POWER STRIP CAPABILITIES

All models include local circuit breaker.

- Surge-protected models include LEDs for convenient local status indication, and also have dry contact closure for remote status notification
- Metered models include high-visibility red LED display; indicates current to tenths of Amps



PDT-1015C-M-NS
PDT Series with local Amp meter



PDT-1015C-RN
PDT Series with 2-stage surge/spike protection

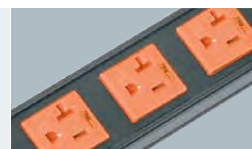

PDT-1620C-NS
PDT Series high density with 16 outlets

PDT SERIES THIN POWER STRIPS

THE INDUSTRY'S LIGHTEST, THINNEST, MOST EASILY INSTALLED POWER STRIPS

	Part #	Chassis Style	Chassis Length	Rated Amperage	# of Outlets	Termination	Protection	Fits Racks Coded	Local Meter	Standard Number
Corded	PDT-615C	PDT	30"	15A	6	9' cord	single stage surge, EMI, circuit breaker	E	No	1, 2, 3, 4
	PDT-615C-NS	PDT	30"	15A	6	9' cord	circuit breaker only	E	No	1, 3
	PDT-1015C-RN	PDT	37-3/4"	15A	10	9' cord	2-stage surge w/remote notification & circuit breaker	G	No	1, 2, 3, 4
	PDT-1015C-NS	PDT	37-3/4"	15A	10	9' cord	circuit breaker only	G	No	1, 3
	PDT-1015C-NS20	PDT	37-3/4"	15A	10	20' cord	circuit breaker only	G	No	1, 3
	PDT-1015C-M-NS	PDT	37-3/4"	15A	10	9' cord	circuit breaker only	G	Yes	1, 3
	PDT-1415C	PDT	60"	15A	14	9' cord	single stage surge, EMI, circuit breaker	N	No	1, 2, 3, 4
	PDT-1415C-NS	PDT	60"	15A	14	9' cord	circuit breaker only	N	No	1, 3
	PDT-1615C-NS	PDT	33-1/2"	15A	16	9' cord	circuit breaker only	E	No	1, 3
	PDT-2015C-RN	PDT	72-3/4"	15A	20	9' cord	2-stage surge w/remote notification & circuit breaker	T	No	1, 2, 3, 4
	PDT-2015C-NS	PDT	72-3/4"	15A	20	9' cord	circuit breaker only	T	No	1, 3
	PDT-2015C-M-NS	PDT	72-3/4"	15A	20	9' cord	circuit breaker only	T	Yes	1, 3
	PDT-620C-NS	PDT	30"	20A	6	9' cord	circuit breaker only	E	No	1, 3
	PDT-1020C-NS	PDT	37-3/4"	20A	10	9' cord	circuit breaker only	G	No	1, 3
	PDT-1220C-NS	PDT	60"	20A	12	9' cord	circuit breaker only	N	No	1, 3
	PDT-1620C-NS	PDT	33-1/2"	20A	16	9' cord	circuit breaker only	E	No	1, 3
	PDT-2020C-NS	PDT	72-3/4"	20A	20	9' cord	circuit breaker only	T	No	1, 3
	PDT-2020C-RN	PDT	72-3/4"	20A	20	9' cord	2-stage surge w/remote notification & circuit breaker	T	No	1, 2, 3, 4
	PDT-2020C-M-NS	PDT	72-3/4"	20A	20	9' cord	circuit breaker only	T	Yes	1, 3
	PDT-2020TL-NS	PDT	72-3/4"	20A	20	9' cord, twistlock plug	circuit breaker only	T	No	1, 3
	PDT-2020TL-M-NS	PDT	72-3/4"	20A	20	9' cord, twistlock plug	circuit breaker only	T	Yes	1, 3

1. Conforms to UL Standard 1363

2. Conforms to UL Standard 1449, 3rd Ed.

3. Certified to CSA Standard C22.2 No. 21

4. Certified to CSA Standard C22.2 No. 8

	Part #	Chassis Style	Circuits/ Rated Amperage	# of Outlets	Chassis Length	Termination	Wire Gauge	Isolated (Technical) Ground	Fits Racks Coded
Hardwired	PDT-2X615S	PDT	(2) 15A	12	30"	J-Box	12	Field Configurable	E
	PDT-2X815	PDT	(2) 15A	16	60"	J-Box	12	Field Configurable	N
	PDT-2X1015	PDT	(2) 15A	20	72-3/4"	J-Box	12	Field Configurable	P
	PDT-2X1015T	PDT	(2) 15A	20	72-3/4"	J-Box	12	Field Configurable	P
	PDT-2X320	PDT	(2) 20A	6	30"	J-Box	12	Field Configurable	E
	PDT-2X520	PDT	(2) 20A	10	44"	J-Box	12	Field Configurable	J
	PDT-2X820	PDT	(2) 20A	16	60"	J-Box	12	Field Configurable	N
	PDT-2X1020	PDT	(2) 20A	20	72-3/4"	J-Box	12	Field Configurable	P
	PDT-2X1020T	PDT	(2) 20A	20	72-3/4"	J-Box	12	Field Configurable	P

1/2" Flex Cable available on request (1'-10' length)

The chart below helps to explain the different features of the PDT Series Power strip.

Part # Ending In	Description
- RN	2-stage surge protection and remote notification
- NS20	Does not include surge protection; includes 20' SignalSAFE™ power cord
- M-NS	Metered – no surge
T	J-Box is located at the top, instead of the bottom of the power strip
- NS	Does not include surge protection